

INITIAL RECEIPT

United States Department of the Interior
Bureau of Land Management
 DIV OF LANDS, MINRLS & ENERGY
 ONE N CENTRAL AVE
 PHOENIX, AZ 85004 -4427
 Phone: 602-417-9200

Receipt

No: 4700099

Transaction #: 4824294	
Date of Transaction: 02/27/2020	
CUSTOMER:	
STEVEN E NEEDHAM 2031 E PARADISE LN PHOENIX, AZ 85022-3439 US	

LINE #	QTY	DESCRIPTION	REMARKS	UNIT PRICE	TOTAL
1	1.00	LOCATABLE MINERALS / MINING CLAIMS-NEW, UNADJUD, ONE OR MORE AUTH NOS / NEW MINING CLAIM PROCESSING FEE CASES: AMC459311/\$20.00		- n/a -	20.00
2	1.00	LOCATABLE MINERALS / MINING CLAIMS-NEW, UNADJUD, ONE OR MORE AUTH NOS / NEW MINING CLAIMS LOCATION FEE CASES: AMC459311/\$40.00		- n/a -	40.00
3	1.00	LOCATABLE MINERALS / MINING CLAIMS-NEW, UNADJUD, ONE OR MORE AUTH NOS / NEW MINING CLAIMS MAINTENANCE FEE CASES: AMC459311/\$165.00		- n/a -	165.00
TOTAL:					\$225.00

PAYMENT INFORMATION			
NOTE: Items will appear on credit card statement as "Bureau of Land Mgmt CO".			
1	AMOUNT:	225.00	POSTMARKED: N/A
	TYPE:	CREDIT CARD	RECEIVED: 02/27/2020
	NAME:	NEEDHAM, STEVEN E 2031 E PARADISE LN PHOENIX AZ 85022-3439 US	
	CARD NO:	XXXXXXXXXXXX2337	AUTH CODE: 06009C
	NAME ON CARD:	STEVEN E NEEDHAM	
	SIGNATURE:		

INTERESTED
 MAR 04 2020
 BY: *RAM*

REMARKS

This receipt was generated by the automated BLM Collections and Billing System and is a paper representation of a portion of the official electronic record contained therein.

MAR 04 2020

CORRESPONDENCE

TRANSFERS

MAINTENANCE FEES

WAIVERS

POL/NOI

MISCELLANEOUS

LOCATION NOTICES
AMENDMENTS
STATUS SHEET
GEO REPORT/MTP

MINING CLAIM STATUS REPORT

Data Entered: 3/4/2020

MTP Checked By: EC

GEO Checked By: EC

LEAD SERIAL NUMBER: AMC 459311 thru AMC _____

NUMBER OF CLAIMS & TYPE:

CHARGES:

1 LODE

PLACER

ASSOCIATION PLACER

MILL SITE

TUNNEL SITE

Processing Fee @ \$20 = \$ 20

Location Fee @ \$40 = \$ 40

Maintenance Fee @ \$165 = \$ 165

Add'l Maint Fee for Assoc Placer = \$ _____

SUBTOTAL \$ 225

TOTAL ACREAGE: 20. Per Claim
(Placer Only)

Other Fees \$ _____

Other Fees \$ _____

NUMBER OF LOCATORS: 1

TOTAL \$ _____

DOCUMENTS RECEIVED VIA: Over-the-Counter Mail **TIMELY FILED:** Yes No

LEGAL DESCRIPTION: T 7N R 1W SEC 12
T _____ R _____ SEC _____
T _____ R _____ SEC _____
T _____ R _____ SEC _____
T _____ R _____ SEC _____

BLM FOREST SERVICE SUBJ TO PL 359: Yes No
WILDERNESS AREA

SPLIT ESTATE: N/A SX PX OTHER
SRHA Was proper Notice filed if located on SHRA Land? Yes No

RECONVEYED MINERALS ON BLM LAND REQUIRE OPENING ORDER FROM 1944 TO 1993:

Open to Entry On _____ N/A

COMMENTS/STATUS: VOID PARTIALLY VOID PVT MINERALS WITHDRAWN LANDS
OTHER

Claimant acknowledges that portions of the following claim(s) site(s) may be void or voidable.

Printed Name of Claimant _____ Signature of Claimant _____

*****FINAL ADJUDICATION*****

DATE _____ INITIALS _____

AMC459311

LOCATION NOTICE FOR PLACER MINING CLAIM

Amendment BLM Serial # _____

NOTICE IS HEREBY GIVEN that the Saguaro Tango
_____ placer mining claim has been located by
Steven E. Needham whose current mailing
address is 2031 E. Paradise Lane, Phoenix
Arizona 85022-3439

RECEIVED
BLM AZ STATE OFFICE
2020 FEB 27 P 3:26
PHOENIX, ARIZONA
BLM
Date
Stamp

The general course of this claim is rectangular and it is situated in Yavapai
County, Arizona. This claim is 1320 feet in length and 660 feet in width.

20 Total Claim Acreage. This claim runs from the location monument on which this location notice is
posted at the SW corner of the claim approximately 1320 feet in a Northerly direction to the
North end line and 660 feet in a Easterly direction to the East end line. This claim is
marked by four monuments, one at each corner of the claim.

The location monument on which this notice is posted is situated within Section 012, Township
007 N, Range 001 W, Gila Salt River Base and Meridian, Arizona. This claim encompasses
portions of the following legal subdivision(s) if located by legal subdivision or the following quarter section(s),
section(s), Township(s) and Range(s) E 1/2 NW 1/4 SE 1/4, Sec. 12, T. 7N., R. 1W.
_____, Gila Salt River Base and Meridian, Arizona.

The locality of this claim with reference to some natural object or permanent monument and additional information
(if any) concerning its locality are as follows: _____

_____ The above information is shown on the attached map.

DATED AND POSTED on the ground this 1st day of December, 2019.

LOCATOR(s) AGENT

Print Name(s) Steven E. Needham

Signature(s) [Handwritten Signature]

Form MCF102
Revised Oct 2018

AMC459311

MINING CLAIM MAP

Lode () Placer (X)
Millsite ()

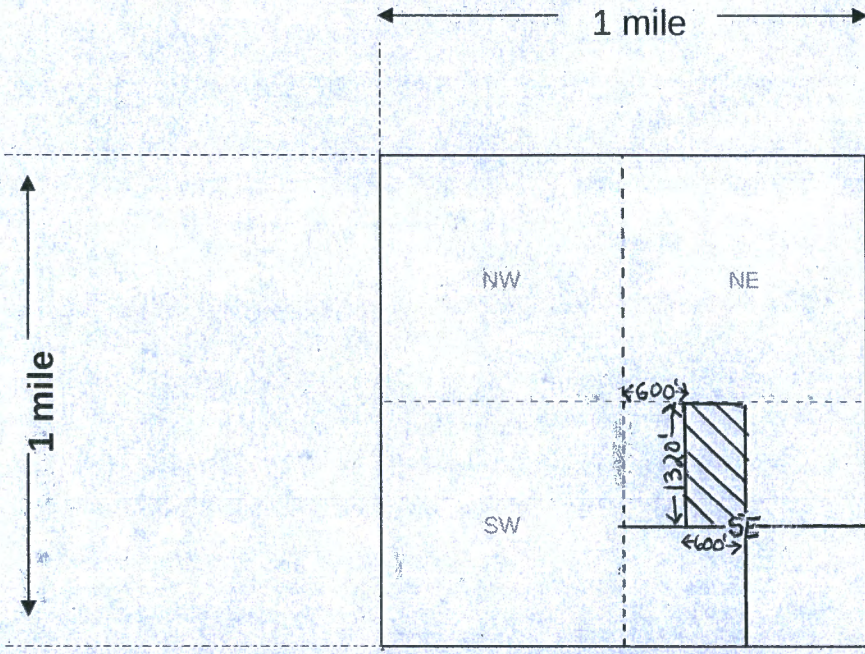

RECEIVED
 BLM AZ STATE OFFICE
 PHOENIX, ARIZONA
 2020 FEB 27 P 3:26

Scale: 1" = 2000 feet



1. The above map depicts the Saguaro Tango mining claim, which is located in Section (s) 012, Township 007 N, Range 001 W, Gila and Salt River Base and Meridian, Yavapai County, Arizona. Total claim acreage is: 20 acre
2. The type of corner and location monuments used are as follows: 4 feet high, 1 1/2" x 1 1/2" solid wood with stone base corner monuments, and location monument
3. The bearings and distances in degrees and feet between claim corners and to a public land survey monument are as depicted on the map.
4. If the claim is a placer or millsite claim with exterior limits conforming to legal subdivisions of the public survey, provide a legal description of the claim The NW corner of the claim is 600' due east of the center of Section 12 T. 7N, R. 1W. GSRM.

AMC459311

Form MCF100a
Revised Oct 2018

Date and Time Run:
3/4/2020 11:37:00 AM

Page 1 of 1

DEPARTMENT OF THE INTERIOR
BUREAU OF LAND MANAGEMENT
Case Recordation

Geographic Report with Land

Disposition is equal to **AUTHORIZED , CANCELLED , EXPIRED , PENDING , REJECTED , RELINQUISHED ,
WITHDRAWN**
and Meridian Township Range Section is equal to 14 0070N 0010W 012
and Admin State is equal to AZ

NO WARRANTY IS MADE BY BLM
FOR USE OF THE DATA FOR
PURPOSES NOT INTENDED BY BLM

DEPARTMENT OF THE INTERIOR
BUREAU OF LAND MANAGEMENT
Case Recordation
Geographic Report with Land

Admin State: AZ
Geo State: AZ

Serial Number	Total Case Acres:	Case type	Case Disp	Mer	Twp	Rng	Sec	Sur Type	Sur # Nr	Suf	Subdivision	Act Pend
AZA 03334	23.666	282201	AUTHORIZED	14	0070N	0010W	012	ALIQ			E2;	
AZA 030330	1.000	293200	EXPIRED					ALIQ			E2;	
AZA 030598	1.000	293200	EXPIRED					FF		1	PORTION OF;	
AZA 030745	1.000	293200	EXPIRED					ALIQ			ALL;	
AZA 031778	1.000	293200	EXPIRED					FF			PORTION OF;	
AZA 032703	2.450	281001	AUTHORIZED					ALIQ			N2;	Y
	2.450											
AZA 034458	1.000	293200	PENDING					FF			PORTION OF;	

